

THIS DRAWING IS THE EXCLUSIVE PROPERTY OF SP INDUSTRIES, INC. AND EMBODIES A CONFIDENTIAL PROPRIETARY DESIGN. SP INDUSTRIES, INC. RESERVES ALL PROPRIETARY RIGHTS IN THIS DRAWING AND IN THE SUBJECT MATERIAL AND INVENTIONS DISCLOSED THEREIN, INCLUDING THE EXCLUSIVE RIGHT TO USE THE DRAWING FOR ALL PURPOSES. THIS DRAWING IS SUBMITTED UNDER A CONFIDENTIAL RELATIONSHIP FOR A SPECIFIC PURPOSE, AND THE RECIPIENT AGREES BY ACCEPTING THIS DRAWING TO NOT TO ALLOW THIS DRAWING TO BE REPRODUCED OR TO SUPPLY OR DISCLOSE ANY INFORMATION REGARDING THE DRAWING OR THE SUBJECT MATTER THEREOF TO ANY OTHER PERSON WITHOUT THE EXPRESS WRITTEN CONSENT OF SP INDUSTRIES, INC.

SYM.	CHANGE OR REVISION	DATE	BY

SP INDUSTRIES
HOPKINS, MICHIGAN 49328

PRINT APPROVAL REQUEST

- APPROVED AS SHOWN
- APPROVED AS MARKED
- NOT APPROVED COMMENTS _____

SIGNED _____ DATE _____

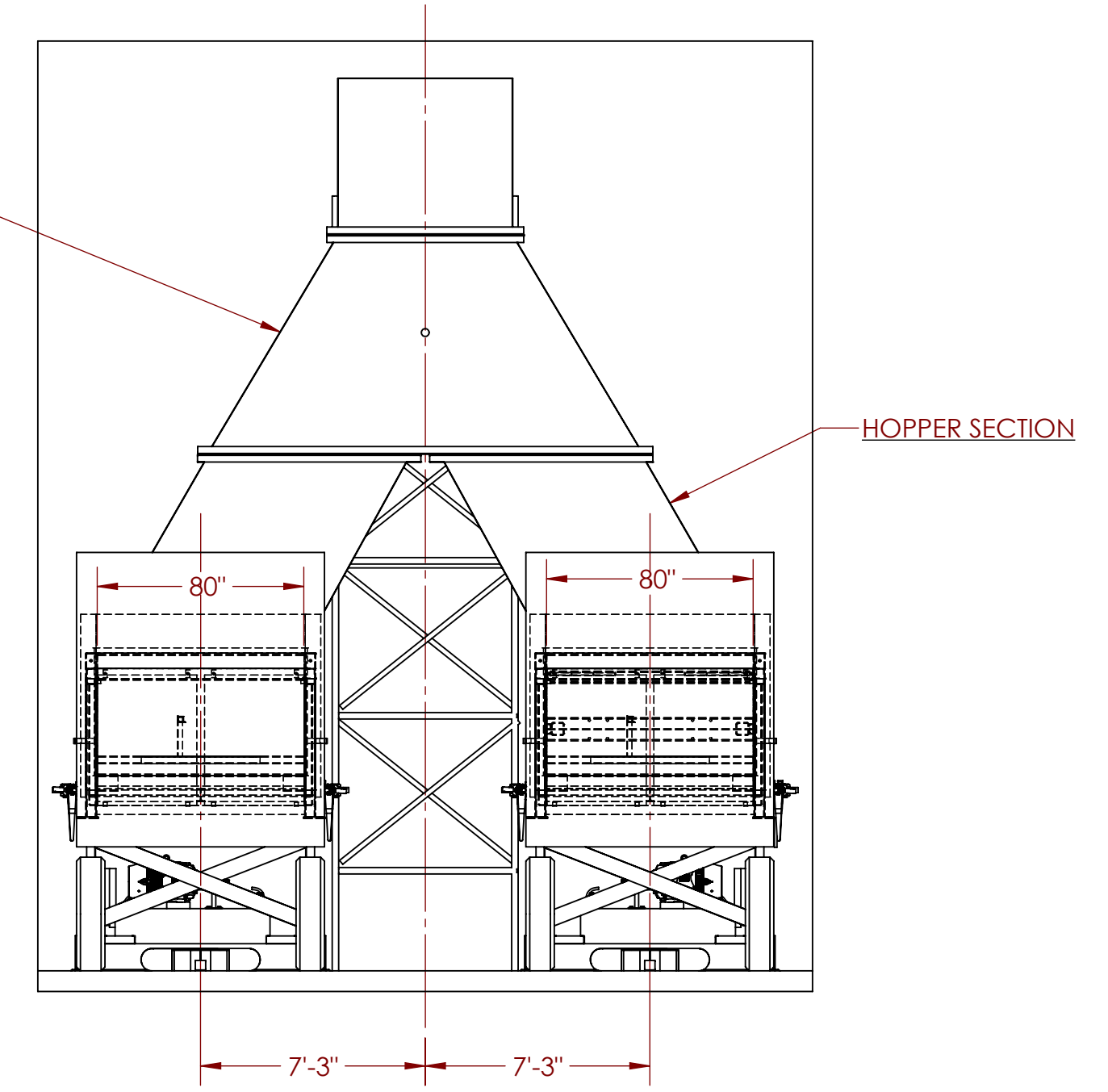
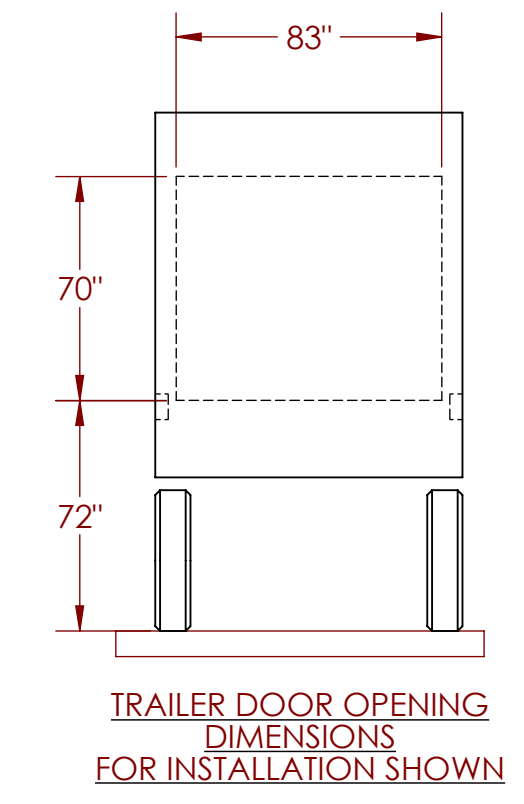
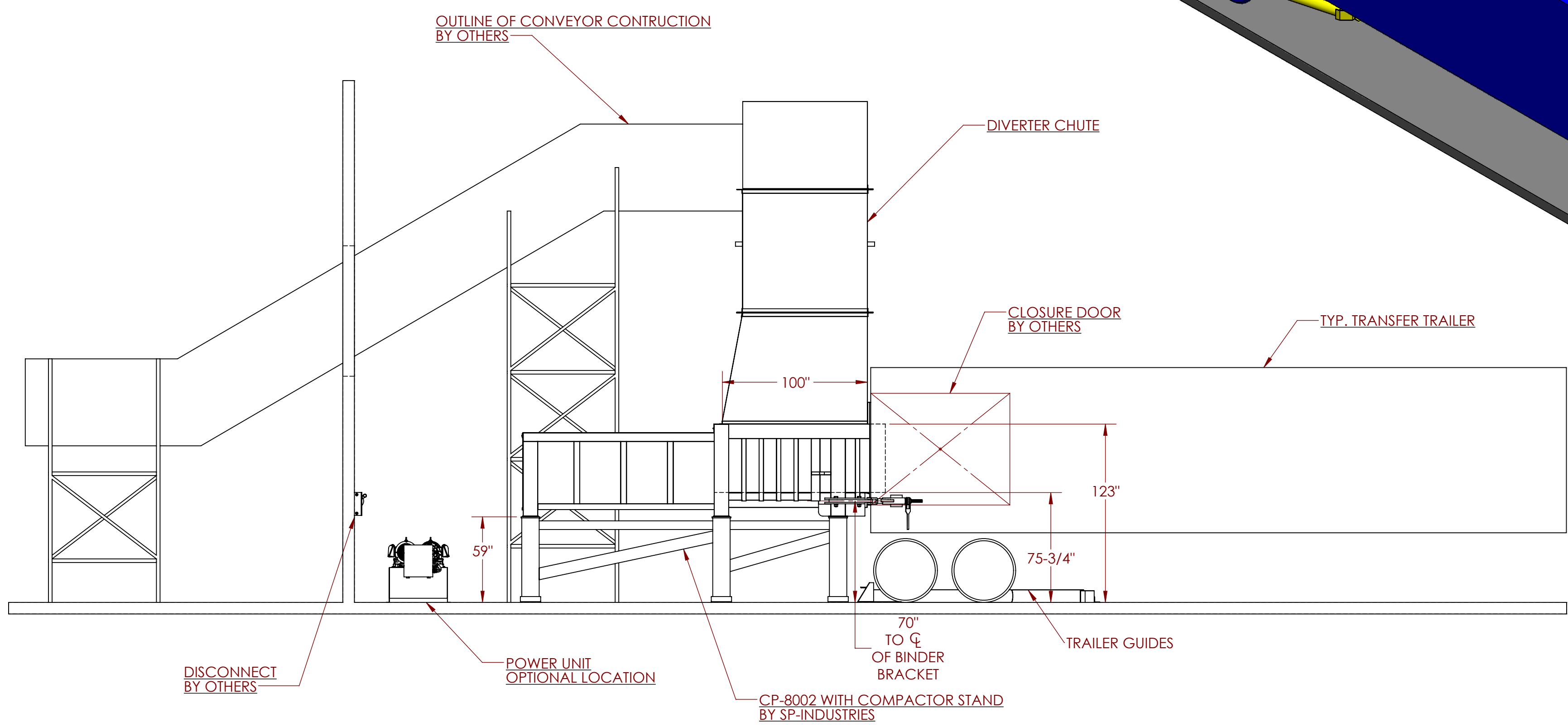
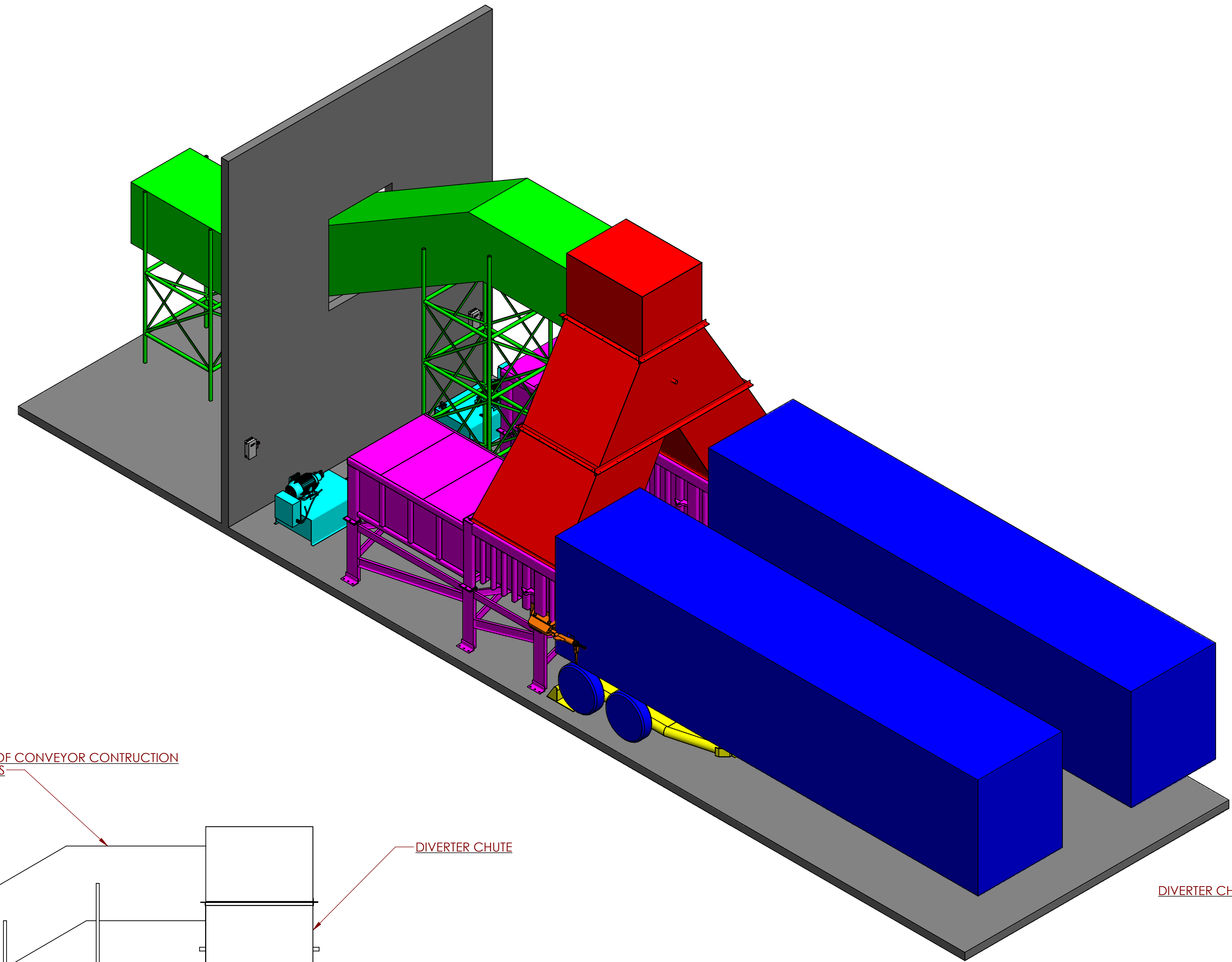

TABLE 1 DISCONNECT & VARIABLE COMPONENTS
COMPONENT VALUES MARKED WITH ASTERISK (*) ARE RECOMMENDED
VALUES ONLY FOR A 10HP MOTOR. INSTALLING CONTRACTOR MUST CONSULT
ALL LOCAL CODES FOR CONFORMITY.

VOLTAGE 3Ø-VAC	FULL LOAD MTR. CURRENT- AMP	SIZE OF (*) DISCONNECT	SIZE OF (*) FUSES (AMP)	RECOMM. (*) WIRE SIZE
460	65.0	100	80.0	4

SP Industries, Inc. *Systems that Work!* HOPKINS, MI

TOLERANCES
FRAC. ±1/16
.XX ±.015
.XXX ±.005

TITLE
DUAL CP-8002 SYSTEMS TO BE FEED BY CONVEYOR SYSTEM
FOR FULCRUM BIO ENERGY INC.

DRAWN C JOHNSON	DATE 09/22/2015	SCALE- 1:60	DRAWING NO. DP-27131	REV.
CHECKED	JOB NO.	WEIGHT:		

D DP-27131 REV. 1